

NOTICE

All instructions, warranties and other collateral documents are subject to change at the sole discretion of Horizon Hobby, LLC. For up-to-date product literature, visit horizonhobby.com and click on the support tab for this product.

Meaning of Special Language

The following terms are used throughout the product literature to indicate various levels of potential harm when operating this product:

NOTICE: Procedures, which if not properly followed, create a possibility of physical property damage AND a little or no possibility of injury.

CAUTION: Procedures, which if not properly followed, create the probability of physical property damage AND a possibility of serious injury.

WARNING: Procedures, which if not properly followed, create the probability of property damage, collateral damage, and serious injury OR create a high probability of superficial injury.

WARNING: Read the ENTIRE instruction manual to become familiar with the features of the product before operating. Failure to operate the product correctly can result in damage to the product, personal property and cause serious injury.

This is a sophisticated hobby product. It must be operated with caution and common sense and requires some basic mechanical ability. Failure to operate this Product in a safe and responsible manner could result in injury or damage to the product or other property. This product is not intended for use by children without direct adult supervision. Do not attempt disassembly, use with incompatible components or augment product in any way without the approval of Horizon Hobby, LLC. This manual contains instructions for safety, operation and maintenance. It is essential to read and follow all the instructions and warnings in the manual, prior to assembly, setup or use, in order to operate correctly and avoid damage or serious injury.

Age Recommendation: Not for children under 14. This is not a toy.

NOTICE: This product is only intended for use with unmanned, hobby-grade, remote-controlled vehicles and aircraft. Horizon Hobby disclaims all liability outside of the intended purpose and will not provide warranty service related thereto.

WARRANTY REGISTRATION

Visit www.spektrumrc.com/registration today to register your product.

Safety precautions

- Always ensure all batteries have been properly charged prior to using the model.
- Always check all servos and their connections prior to each run.
- Never operate your model near spectators, parking areas or any other area that could result in injury to people or damage of property.
- Never operate your model during adverse weather conditions. Poor visibility can cause disorientation and loss of control of your model.
- Never point the transmitter antenna directly toward the model. The radiation pattern from the tip of the antenna is inherently low.
- If at any time during the operation of your model you observe any erratic or abnormal operation, immediately stop operation of your model until the cause of the problem has been ascertained and corrected.

Charging Warnings

- Failure to exercise caution while using this product and comply with the following warnings could result in product malfunction, electrical issues, excessive heat, FIRE, and ultimately injury and property damage.
- Read all safety precautions and literature prior to use of this product
- Never allow minors to charge battery packs
- Never drop charger or batteries
- Never attempt to charge damaged batteries
- Never attempt to charge a battery pack containing different types of batteries
- Never charge a battery if the cable has been pinched or shorted
- Never allow batteries or battery packs to come into contact with moisture at any time
- Never charge batteries in extremely hot or cold places (recommended between 50–80° F or 10–27° C) or place in direct sunlight
- Always disconnect the transmitter after charging, and let the charger cool between charges
- Always inspect a new battery before charging
- Always terminate all processes and contact Horizon Hobby if the product malfunctions
- Always keep batteries and charger away from any material that could be affected by heat (such as ceramic and tile), as they can get hot
- Always end the charging process if the charger or battery becomes hot to the touch or starts to change form (swell) during the charge process

TRANSMITTER FUNCTIONS

Function	Function
A Button L	M Button F
B Roller Wheel	N Button G
C Button R	O Button H
D Color Touch Screen	P Trigger (throttle/brake)
E Steering Wheel	Q Button A
F Power Button	R Button E
G Power LED	S Button D
H Memory Card/USB Port	T Button C
I switch I	U Speaker
J Knob	V Antenna
K Head Phone Jack	W Charge Base
L Button B	

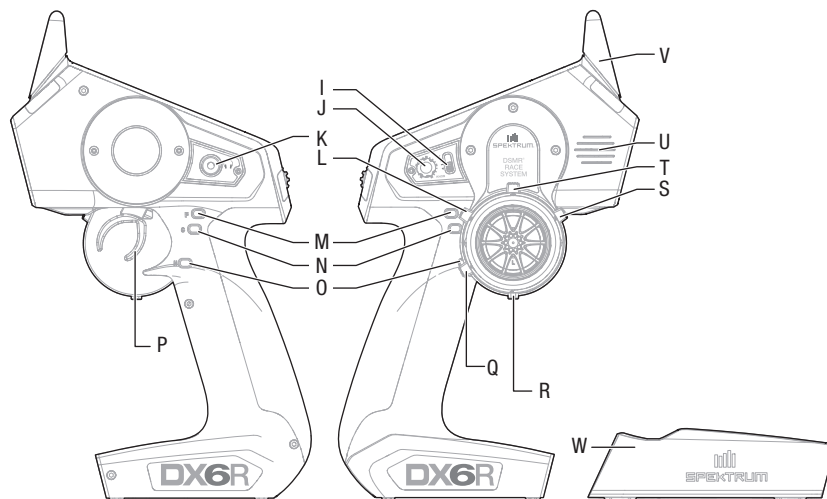
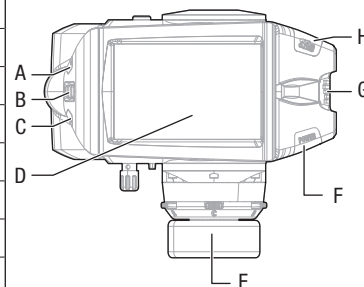

48103

© 2016 Horizon Hobby, LLC.

DSM2, DSMR and RaceWare are trademarks or registered trademarks of Horizon Hobby, LLC.

The Spektrum trademark is used with permission of Bachmann Industries, Inc.

Android is a trademark of Google Inc. The Bluetooth® word mark and logos are registered trademarks owned by Bluetooth SIG, Inc. and any use of such marks by Horizon Hobby is under license. The WiFi logo is a registered trademark of WiFi Alliance. The SD Logo is a trademark of SD-3C, LLC.

All other trademarks, service marks and logos are property of their respective owners. Patents pending.

05/16



DX6R

6-Channel 2.4GHz DSMR® System

CHARGING

The DX6R has a charging base designed to charge the transmitters 4000mAh Li-Ion Transmitter Pack at a charge rate of 400mAh.

The first time you charge the transmitter, the charge time may be 15-20 hours. Always charge the transmitter on a heat-resistant surface.

Charging:

1. Either power off your transmitter or make sure the transmitter is not transmitting (no orange LED).
2. Connect the AC power cable to the charging base and connect the power supply to a power outlet using the appropriate adapter.
3. Carefully set the transmitter down onto the charging base.
4. The LED on the transmitter turns blue during charging and turns off when the battery is fully charged.
5. Disconnect the transmitter from the charging base once charging is complete and disconnect the power supply from the power outlet.



CAUTION: Never leave a charging battery unattended.



CAUTION: Never change the low voltage limit for Li-Ion batteries below 3.3V. Doing so could over-discharge the battery and damage both battery and transmitter.

LED indicators

- The LED will turn blue to indicates the battery is charging and turns off when the battery is fully charged.
- An orange LED indicates the transmitter is powered on and there is radio transmission.

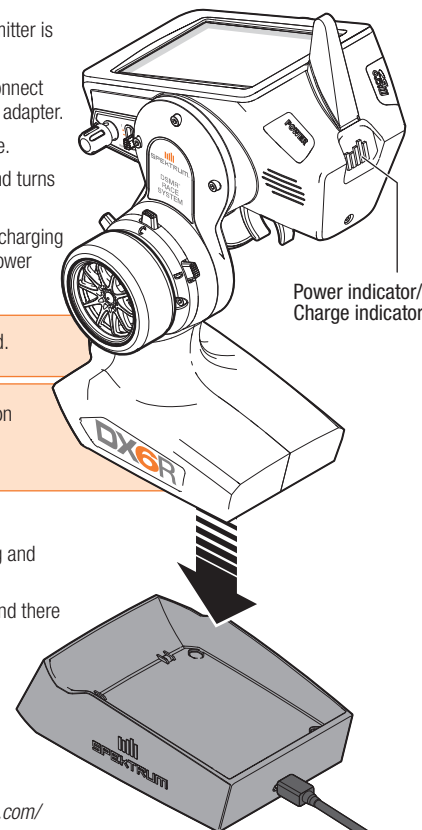

Support Videos:

For helpful videos on programing the Spektrum™ DX6R and other Spektrum Transmitters go to <https://www.spektrumrc.com/>

NAVIGATION

The DX6R is built on top of the Android operating system and features a large color touch screen display.

To navigate around the DX6R use your finger to tap, swipe and drag icons and menus found on the display.



Home Screen

1. **APP DRAWER:** Contains applications loaded onto the DX6R.
2. **BACK:** Return to previous screen.
3. **HOME:** Return to the home screen
4. **OVERVIEW:** Allows switching between any of the running applications.

Tips

The DX6R application will hide the home screen navigation icons. Access the Navigation icons at anytime by swiping up from the bottom of the screen.

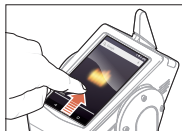

Notification Screen

Swipe down from the top of the screen for quick access to:

1. Settings
2. User info
3. Screen brightness
4. Wi-fi
5. Bluetooth
6. Notifications

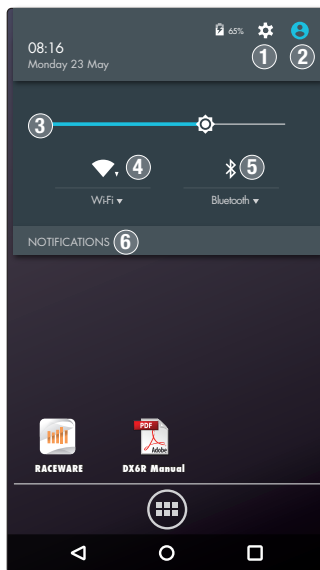
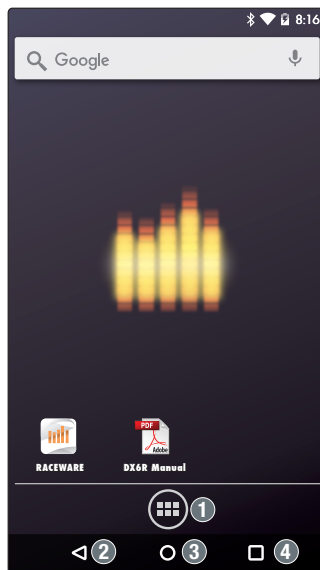

START UP

1. Turn the DX6R on by pushing and holding the power button for several seconds. The DX6R will begin to boot up.
2. After the operating system loads, swipe up on the lock screen to unlock the system.
3. Swipe down from the top of the screen for quick access to the settings menu, Wi-fi, Bluetooth and user settings.
4. Once the Android settings have been made you can launch the RaceWare Application.
5. The RaceWare™ Application will be found on the home screen or in the App Drawer. Tap on the icon with your finger and the application will launch.
6. The Setup Assistant will open at first start up to aid in creating a new model. The Setup Assistant can be accessed at any time by going to the setup page in the RaceWare app.

Tips

- For more information on operating the DX6R, the full manual can be found on the home screen.
- For more information on using the Android OS, scan the QR code or follow the link below.

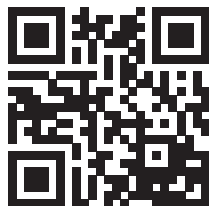

https://static.googleusercontent.com/media/www.google.com/en/us/help/hc/images/android/android Ug_50/Android-Lollipop-Quick-Start-Guide.pdf

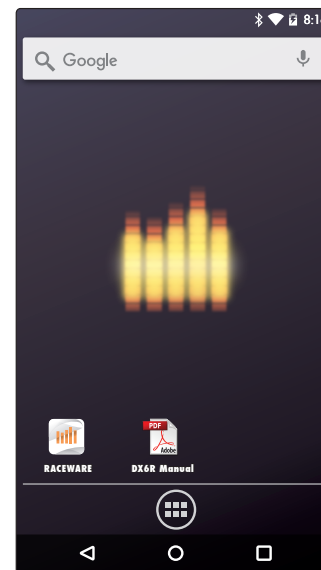
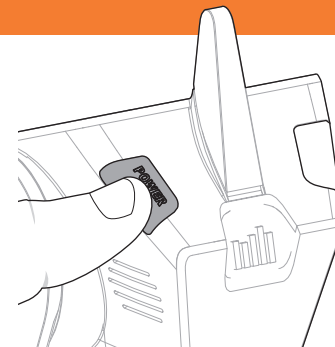

MICRO-SD CARD/MICRO-USB

The Micro-SD card (not included) and Micro-USB port enable you to:

- Import (copy) models from any compatible Spektrum RaceWare™ transmitter
- Export (transfer) models to any Spektrum RaceWare transmitter
- Update RaceWare software in the transmitter
- Install/Update sound files
- Install/Update Operating system files

To install the Micro-SD Card:

1. Lift off the rubber dust cover
2. Press the Micro-SD Card into the card slot with the card label facing as shown

Connect a Micro-USB:

1. Power off the transmitter
2. lift off the rubber dust cover
3. Connect the Micro-USB cord (not included) to the transmitter and a PC.
4. Power on the transmitter

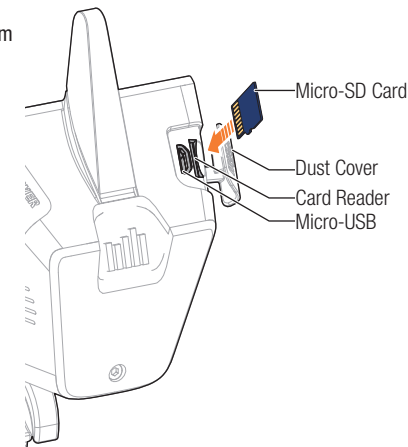

INCLUDED SR2000/SR600T RECEIVERS

SR2000 Micro Race receiver

The Spektrum™ SR2000 DSMR® Micro Race receiver is compatible with all Spektrum DSMR transmitters and is also backwards compatible with DSM2® transmitters. The SR2000 receiver is NOT compatible with DSM® transmitters.

Specifications

Type: DSMR
Dimensions (LxWxH): 25.5 x 17.6 x 13.6mm
Channels: 2
Weight: 5.5 g
Band: 2.4GHz
Voltage Range: 3.5–9.6V



SR600T Telemetry Receiver

The Spektrum SR600T Telemetry Receiver is compatible with all Spektrum DSMR surface transmitters. Telemetry functions require a Spektrum transmitter capable of telemetry.

Specifications

Type: DSMR with internal telemetry
Dimensions (LxWxH): 37.5 x 27.7 x 15.7mm
Antenna Length: 210mm
Channels: 6
Weight: 9.2 g
Band: 2.4GHz
Voltage Range: 3.5–9.6V



For full receiver manuals scan the QR Codes or go to <https://www.spektrumrc.com/>